

The **GEMINI** model features the use of the hydraulic motor complete with a hydraulic control unit with 12/24 VDC or 230VAC power supply housed in the base of the hose reel which allows it to keep to a minimum the overall dimensions. The hydraulic power of the motor ensures the guided rewinding of long length hoses and with bigger diameters. It is equipped as standard with **HOVA[®]** hose guide.

NOTE: in this version the rewinding occurs via the use of the hydraulic motor, meanwhile the unwinding of the hose must be done manually.

It can be controlled from a button panel, from a remote control or directly from the complete control panel (see bottom of page)

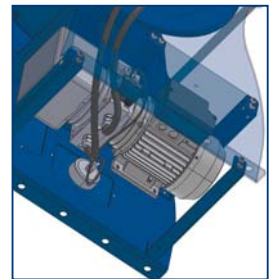
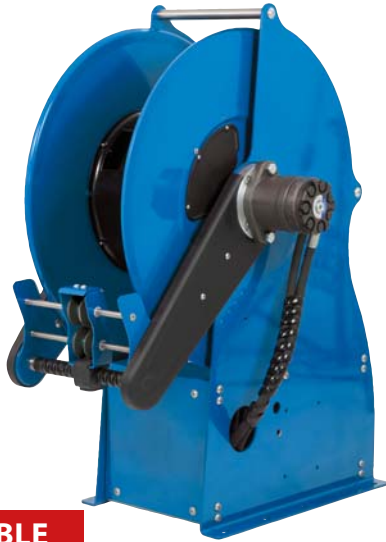

- 3 VERSIONS AVAILABLE**
- Painted steel;
 - Aisi 304;
 - Aisi 316

- LEGEND**
- A **HOVA[®]** hose guide
 - B1 Swivel joint side base arm
 - B2 Hydraulic motor side base arm
 - C Hydraulic motor
 - D Swivel Joint
 - E Hose exit side disc/drum assembly
 - F Compartment for electro-hydraulic motor

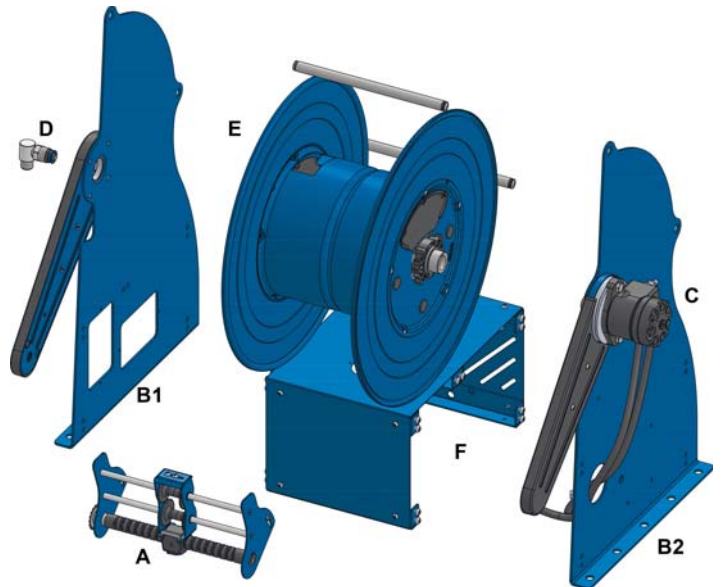

HEAVY DUTY
 Thanks to the use of the hydraulic motor (C) the GEMINI is capable of easily rewinding hoses of great lengths and dimensions.

BUTTON PANEL OPTIONAL

REMOTE CONTROL OPTIONAL

COMPLETE CONTROL PANEL AS STANDARD



500 SERIES - G1 Ø Disc 540 mm - Spool 195 mm - Drum 250 mm

	Art.no. 12 VDC	Art.no. 24 VDC	Art.no. 230 VAC	Art.no. WITHOUT POWER SUPPLY	Max. pressure joint	Connection threads IN - OUT	Max diameter hose	Max length hose (m)	Swivel joint*
PAINTED STEEL	GF1252190	GF2452190	GF2352190	GFSGA52190	600 bar	1/2"(M) 1/2"(F)	1/4"	130	9951
							3/8"	85	
							1/2"	65	
	GF1252191	GF2452191	GF2352191	GFSGA52191	100 bar	1"(M)- 3/4"(F)	3/4"	30	9970
							1"	18	
AISI 304 STAINLESS STEEL	GX1252190	GX2452190	GX2352190	GXSGA52190	200 bar	1/2"(M) 1/2"(F)	1/4"	130	9968
							3/8"	85	
							1/2"	65	
	GX1252191	GX2452191	GX2352191	GXSGA52191	100 bar	1"(M)- 3/4"(F)	3/4"	30	9970
							1"	18	



500 SERIES - G2 Ø Disc 540 mm - Spool 260 mm - Drum 250 mm

	Art.no. 12 VDC	Art.no. 24 VDC	Art.no. 230 VAC	Art.no. WITHOUT POWER SUPPLY	Max. pressure joint	Connection threads IN - OUT	Max diameter hose	Max length hose (m)	Swivel joint*
PAINTED STEEL	GF1252260	GF2452260	GF2352260	GFSGA52260	600 bar **	1/2"(M) 1/2"(F)	1/4"	180	9951
							3/8"	115	
							1/2"	90	
	GF1252261	GF2452261	GF2352261	GFSGA52261	100 bar	1"(M)- 3/4"(F)	3/4"	40	9970
							1"	25	
AISI 304 STAINLESS STEEL	GX1252260	GX2452260	GX2352260	GXSGA52260	200 bar **	1/2"(M) 1/2"(F)	1/4"	180	9968
							3/8"	115	
							1/2"	90	
	GX1252261	GX2452261	GX2352261	GXSGA52261	100 bar	1"(M)- 3/4"(F)	3/4"	40	9970
							1"	25	



600 SERIES - G3 Ø Disc 600 mm - Spool 260 mm - Drum 335 mm

	Art.no. 12 VDC	Art.no. 24 VDC	Art.no. 230 VAC	Art.no. WITHOUT POWER SUPPLY	Max. pressure joint	Connection threads IN - OUT	Max diameter hose	Max length hose (m)	Swivel joint*					
PAINTED STEEL	GF1263260	GF2463260	GF2363260	GFSGA63260	600 bar **	1/2"(M) 1/2"(F)	1/4"	200	9951					
							3/8"	150						
							1/2"	110						
	GF1263261	GF2463261	GF2363261	GFSGA63261	100 bar	1"(M)- 3/4"(F)	3/4"	55	9970					
							1"	32						
	GF1263262	GF2463262	GF2363262	GFSGA63262	20 bar	1 1/4"(M)- 1 1/4"(M)	1 1/4"	22	9980					
							GF1263263	GF2463263		GF2363263	GFSGA63263	1 1/4"(M)- 1 1/2"(M)	15	9949
AISI 304 STAINLESS STEEL	GX1263260	GX2463260	GX2363260	GXSGA63260	200 bar **	1/2"(M) 1/2"(F)	1/4"	200	9968					
							3/8"	150						
							1/2"	110						
	GX1263261	GX2463261	GX2363261	GXSGA63261	100 bar	1"(M)- 3/4"(F)	3/4"	55	9970					
							1"	32						
	GX1263262	GX2463262	GX2363262	GXSGA63262	20 bar	1 1/4"(M)- 1 1/4"(M)	1 1/4"	22	9946					
							GX1263263	GX2463263		GX2363263	GXSGA63263	1 1/4"(M)- 1 1/2"(M)	15	9945

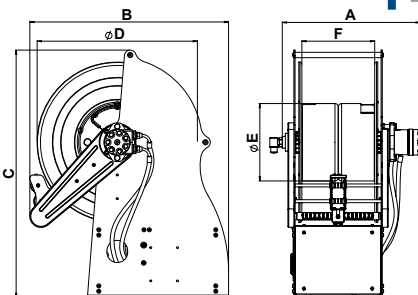

*) The reels in painted steel are equipped with mineral oil compatible swivel joint gaskets. The hose reels in stainless steel come with water-compatible Viton® swivel joint gaskets. See pages 227 for the complete range of swivel joints with gaskets compatible with other liquids.

***) When ordering, specify whether or not the application implies the use of low pressure hoses (see page 226 regarding the splitting of the roller).

DIMENSIONS AND PACKAGING

Art.no.	D (mm)	F (mm)	E (mm)	A-B-C (mm)	Packaging dimensions (mm)	Weight (kg)
G1	540	195	250	385x670x834	670x800x900	56
G2	540	260	250	450x670x834	670x800x900	63
G3	600	260	335	450x730x894	670x800x900	68