

The **SIRIO motorized** hose reel is compact and can work with different motors, which can operate with a speed variator (24VDC / 12VDC models). If needed, a 230VAC / 24VDC power supply can be supplied separately (optional). (Art.no. 75070 (24VDC) / 75070/12 (12VDC)).

In heavy duty application where more power is needed in order to rewind the hose, SIRIO can be supplied with a hydraulic motor which can be powered by a 12/24 VDC or 230 VAC control unit.

NOTE: in this version the rewinding occurs via the use of the hydraulic motor, meanwhile the unwinding of the hose must be done manually.

**OPTIONAL:** crank to allow manual winding of the hose.

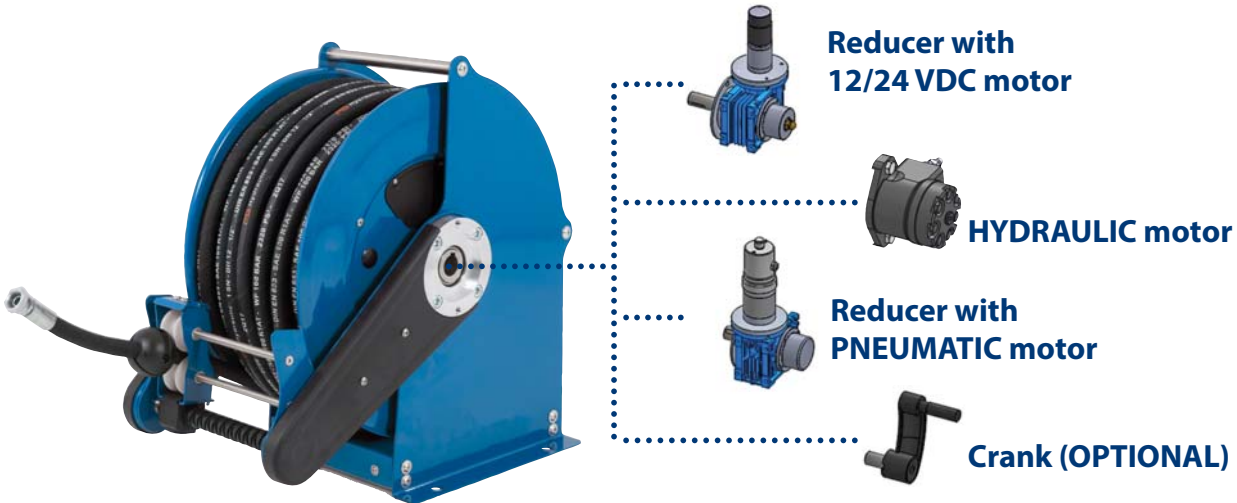

**BUTTON PANEL**



Art.no. 25103

**OPTIONAL CONTROLS**

**REMOTE CONTROL**



Art.no. 25101

**POWER SUPPLY/CONVERTER**

230V – 12/24 Vdc



Art.no. 75070/12 (12VDC)  
Art.no. 75070 (24VDC)

**SIMPLIFIED CONTROL PANEL**



Art.no. 25107/12 (12VDC)  
Art.no. 25107/24 (24VDC)

**CONTROL PANEL WITH SPEED REGULATOR**



Art.no. 25108/12 (12VDC)  
Art.no. 25108/24 (24VDC)

**COMPLETE CONTROL PANEL AS STANDARD**



Art.no. 25104 (230VAC)  
Art.no. 25105 (12VDC)  
Art.no. 25106 (24VDC)

### VERSION WITH REDUCED DIMENSIONS



### COMPACT VERSION

12/24V Motor

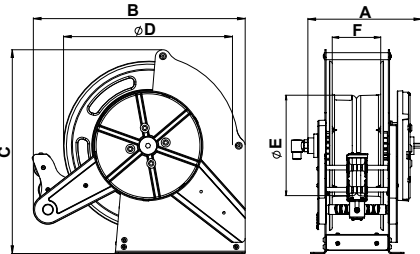

SIRIO COMPACT hose reel with chain drive and with 12/24 VDC motor.

## 400 SERIES - SC1 Ø Disc 434 mm - Spool 130 mm - Drum 250 mm

	Art.no. 12 VDC	Art.no. 24 VDC	Max. pressure joint	Connection threads IN - OUT	Max diameter hose	Max length hose (m)	Swivel joint*
<b>PAINTED STEEL</b>	SCF1242130	SCF2442130	600 bar **	1/2"(M) 1/2"(F)	1/4"	40	9951
					3/8"	25	
					1/2"	18	
	SCF1242131	SCF2442131	100 bar	1"(M)-3/4"(F)	3/4"	12	9970
				1"	8		
<b>AISI 304 STAINLESS STEEL</b>	SCX1242130	SCX2442130	200 bar **	1/2"(M) 1/2"(F)	1/4"	40	9968
					3/8"	25	
					1/2"	18	
	SCX1242131	SCX2442131	100 bar	1"(M)-3/4"(F)	3/4"	12	9970
				1"	8		

\*) The reels in painted steel are equipped with mineral oil compatible swivel joint gaskets. The hose reels in stainless steel come with water-compatible Viton<sup>®</sup> swivel joint gaskets. See pages 227 for the complete range of swivel joints with gaskets compatible with other liquids.

\*\*\*) When ordering, specify whether or not the application implies the use of low pressure hoses (see page 226 regarding the splitting of the roller).

### DIMENSIONS AND PACKAGING

Art.no.	D (mm)	F (mm)	E (mm)	A-B-C (mm)	Packaging dimensions (mm)	Weight (kg)
<b>SC1</b>	434	130	250	335x544x524	670x800x900	26

## SIRIO ID

## HYDRAULIC MOTOR DRIVEN HOSE REEL

In the SIRIO ID version the hydraulic control unit (available with 12/24 VDC or 230 VAC power supply) is supplied separately and its housing must be managed by the end user.



**F1** – Control unit 12/24VDC  
Art.no. 22024 (24VDC)  
Art.no. 22012 (12VDC)



**F2** – Control unit 230 VAC  
Art.no. 22023

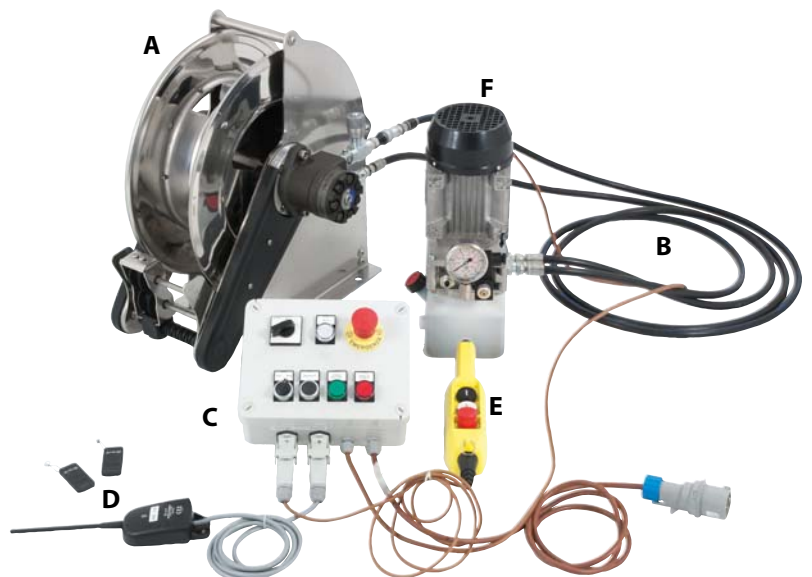

### EXAMPLE OF COMPLETE HYDRAULIC KIT

- A SIRIO ID hydraulic hose reel
- B Hydraulic pipes (optional)
- C Complete control panel (optional)
- D Remote control (optional)
- E Button panel (optional)
- F Electro-hydraulic control unit (optional)

STANDARD VERSION

Hose Reels



**400 SERIES - S1** Ø Disc 434 mm - Spool 130 mm - Drum 250 mm

	Art.no. 12 VDC	Art.no. 24 VDC	Art.no. ID HYDRAULIC	Art.no. PNEUMATIC	Max. pressure joint	Connection threads IN - OUT	Max diameter hose	Max length hose (m)	Swivel joint*
<b>PAINTED STEEL</b>	SF1242130	SF2442130	SFID42130	SFPN42130	600 bar **	1/2"(M) 1/2"(F)	1/4"	40	9951
							3/8"	25	
							1/2"	18	
	SF1242131	SF2442131	SFID42131	SFPN42131	100 bar	1"(M)-3/4"(F)	3/4"	12	9970
							1"	8	
<b>AISI 304 STAINLESS STEEL</b>	SX1242130	SX2442130	SXID42130	SXPN42130	200 bar **	1/2"(M) 1/2"(F)	1/4"	40	9968
							3/8"	25	
							1/2"	18	
	SX1242131	SX2442131	SXID42131	SXPN42131	100 bar	1"(M)-3/4"(F)	3/4"	12	9970
							1"	15	

**400 SERIES - S2** Ø Disc 434 mm - Spool 195 mm - Drum 250 mm

	Art.no. 12 VDC	Art.no. 24 VDC	Art.no. ID HYDRAULIC	Art.no. PNEUMATIC	Max. pressure joint	Connection threads IN - OUT	Max diameter hose	Max length hose (m)	Swivel joint*
<b>PAINTED STEEL</b>	SF1242190	SF2442190	SFID42190	SFPN42190	600 bar **	1/2"(M) 1/2"(F)	1/4"	50	9951
							3/8"	40	
							1/2"	30	
	SF1242191	SF2442191	SFID42191	SFPN42191	100 bar	1"(M)-3/4"(F)	3/4"	18	9970
							1"	12	
<b>AISI 304 STAINLESS STEEL</b>	SX1242190	SX2442190	SXID42190	SXPN42190	200 bar **	1/2"(M) 1/2"(F)	1/4"	60	9968
							3/8"	40	
							1/2"	30	
	SX1242191	SX2442191	SXID42191	SXPN42191	100 bar	1"(M)-3/4"(F)	3/4"	18	9970
							1"	12	

**400 SERIES - S3** Ø Disc 434 mm - Spool 260 mm - Drum 250 mm

	Art.no. 12 VDC	Art.no. 24 VDC	Art.no. ID HYDRAULIC	Art.no. PNEUMATIC	Max. pressure joint	Connection threads IN - OUT	Max diameter hose	Max length hose (m)	Swivel joint*
<b>PAINTED STEEL</b>	SF1242260	SF2442260	SFID42260	SFPN42260	600 bar **	1/2"(M) 1/2"(F)	1/4"	60	9951
							3/8"	50	
							1/2"	40	
	SF1242261	SF2442261	SFID42261	SFPN42261	100 bar	1"(M)-3/4"(F)	3/4"	20	9970
							1"	15	
<b>AISI 304 STAINLESS STEEL</b>	SX1242260	SX2442260	SXID42260	SXPN42260	200 bar **	1/2"(M) 1/2"(F)	1/4"	60	9968
							3/8"	50	
							1/2"	40	
	SX1242261	SX2442261	SXID42261	SXPN42261	100 bar	1"(M)-3/4"(F)	3/4"	20	9970
							1"	15	

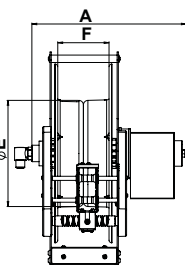
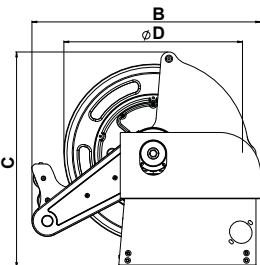

\*) The reels in painted steel are equipped with mineral oil compatible swivel joint gaskets. The hose reels in stainless steel come with water-compatible Viton® swivel joint gaskets. See pages 227 for the complete range of swivel joints with gaskets compatible with other liquids.

\*\* ) When ordering, specify whether or not the application implies the use of low pressure hoses (see page 226 regarding the splitting of the roller).

**DIMENSIONS AND PACKAGING**

Art.no.	D (mm)	F (mm)	E (mm)	A-B-C (mm)	Packaging dimensions (mm)	Weight (kg)
<b>S1</b>	434	130	250	358x544x538	670x800x900	23
<b>S2</b>	434	195	250	426x544x538	670x800x900	26
<b>S3</b>	434	260	250	491x544x538	670x800x900	28



**500 SERIES - S4** Ø Disc 540 mm - Spool 130 mm - Drum 250 mm

	Art.no. 12 VDC	Art.no. 24 VDC	Art.no. ID HYDRAULIC	Art.no. PNEUMATIC	Max. pressure joint	Connection threads IN - OUT	Max diameter hose	Max length hose (m)	Swivel joint*
<b>PAINTED STEEL</b>	SF1252130	SF2452130	SFID52130	SFPN52130	600 bar **	1/2"(M) 1/2"(F)	1/4"	80	9951
							3/8"	60	
							1/2"	45	
	SF1252131	SF2452131	SFID52131	SFPN52131	100 bar	1"(M)-3/4"(F)	3/4"	22	9970
						1"	12		
<b>AISI 304 STAINLESS STEEL</b>	SX1252130	SX2452130	SXID52130	SXPNS2130	200 bar **	1/2"(M) 1/2"(F)	1/4"	80	9968
							3/8"	60	
							1/2"	45	
	SX1252131	SX2452131	SXID52131	SXPNS2131	100 bar	1"(M)-3/4"(F)	3/4"	22	9970
						1"	12		

**500 SERIES - S5** Ø Disc 540 mm - Spool 195 mm - Drum 250 mm

	Art.no. 12 VDC	Art.no. 24 VDC	Art.no. ID HYDRAULIC	Art.no. PNEUMATIC	Max. pressure joint	Connection threads IN - OUT	Max diameter hose	Max length hose (m)	Swivel joint*
<b>PAINTED STEEL</b>	SF1252190	SF2452190	SFID52190	SFPN52190	600 bar **	1/2"(M) 1/2"(F)	1/4"	120	9951
							3/8"	90	
							1/2"	70	
	SF1252191	SF2452191	SFID52191	SFPN52191	100 bar	1"(M)-3/4"(F)	3/4"	35	9970
						1"	18		
<b>AISI 304 STAINLESS STEEL</b>	SX1252190	SX2452190	SXID52190	SXPNS2190	200 bar **	1/2"(M) 1/2"(F)	1/4"	120	9968
							3/8"	90	
							1/2"	70	
	SX1252191	SX2452191	SXID52191	SXPNS2191	100 bar	1"(M)-3/4"(F)	3/4"	35	9970
						1"	18		

**500 SERIES - S6** Ø Disc 540 mm - Spool 260 mm - Drum 250 mm

	Art.no. ID HYDRAULIC	Max. pressure joint	Connection threads IN - OUT	Max diameter hose	Max length hose (m)	Swivel joint*
<b>PAINTED STEEL</b>	SFID52260	600 bar **	1/2"(M) 1/2"(F)	1/4"	180	9951
				3/8"	115	
				1/2"	90	
<b>AISI 304 STAINLESS STEEL</b>	SXID52260	200 bar **	1/2"(M) 1/2"(F)	1/4"	180	9968
				3/8"	115	
				1/2"	90	

**ELECTRIC MOTOR FOR SIRIO**

Motor	Voltage	Absorption	Power output	Rpm
<b>MS12V</b>	12VDC	4.5A	55W	4500
<b>MS24V</b>	24VDC	3.75A	90W	3000

\*) The reels in painted steel are equipped with mineral oil compatible swivel joint gaskets. The hose reels in stainless steel come with water-compatible Viton® swivel joint gaskets. See pages 227 for the complete range of swivel joints with gaskets compatible with other liquids.

\*\*\*) When ordering, specify whether or not the application implies the use of low pressure hoses (see page 226 regarding the splitting of the roller).

**DIMENSIONS AND PACKAGING**

Art.no.	D (mm)	F (mm)	E (mm)	A-B-C (mm)	Packaging dimensions (mm)	Weight (kg)
<b>S4</b>	540	130	250	358x594x632	670x800x900	26
<b>S5</b>	540	195	250	426x598x632	670x800x900	28
<b>S6</b>	540	260	250	504x604x632	670x800x900	32

