

1000-U158

Housing for stepped cam, Zinc die chrome-plated; 1000-U158

Product image



Drawing

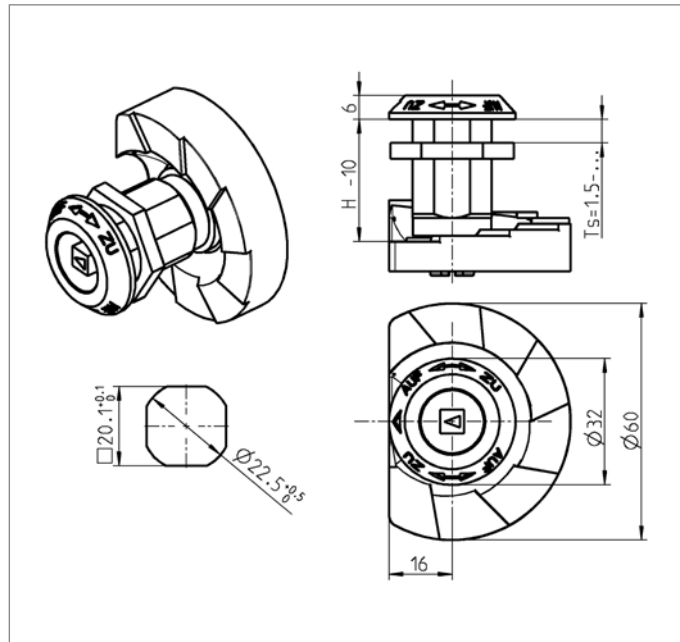

Product information

Housing with 270° stopper

Key Features

- This product is a modular component of a UL-certified closure.

Properties

Foamed gasket	no
Door version	Left; Right
Housing head shape	Round
Housing head size	32 x 6 mm
Quarter turn type	Quarter turn with simple insert
Locking set	Insert
Grounding possible	no
Cap dimension L	
Mounting position	Inside the sealing
Locking component	Stepped cam
Number of possible locking points	1 point
Fixing type of housing	nut fixing
Integrated seal	no

Properties

Material of the module	Zinc die
Surface of the module	chrome-plated
Suitable for door thicknesses up to	20.0 mm
Suitable for door thickness from	1.5 mm
Dimension GH, length of housing	30.0 mm
Parts list	Housing for insert and for stepped cam, Zinc die chrome-plated Nut M22x1.5, Steel zinc-plated

The above information is given to the best of our knowledge. The tests are carried out under laboratory conditions and therefore have the character of a general recommendation. The suitability of our product for the respective application must, if necessary, be checked and verified by our own tests "under original conditions".

1000-U158

Housing for stepped cam, Zinc die chrome-plated; 1000-U158

Cut out

