

Screw connectors for shielded copper wires

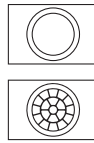
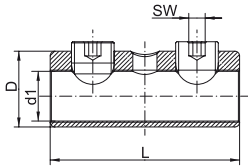

- ▶ For connecting different conductor types and materials, e.g. to DIN EN 60228 Class 1 and 2
- ▶ Ideal for connecting identical and different conductor cross-sections
- ▶ Suitable cross-section range for example shielded copper wires

Characteristics

- Special groove profile inside to destroy the oxidation layer when crimping
- With inspection hole for monitoring full cable insertion

Material

- Insulated body: brass (CuZn)
- Screws: stainless steel, tin-plated

Surface

- Tin-plated to protect against corrosion

Technical instructions

- Refer to the installation instructions in the technical appendix on page i-8

Additional information

- rm = round multi-stranded; re = round single solid

Part No.	Nominal cross section mm ²		Dimension mm				Torque Nm	Weight/pcs. ~kg	Packing unit/ pcs
	re	rm	D	d1	L	AF			
SV100	6 - 35	6 - 25	14	7.2	40	4	10	3.9	4

Screw connectors for street lighting

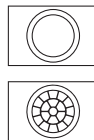
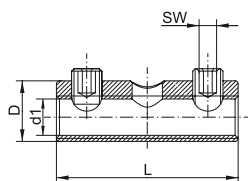

- ▶ For connecting different conductor types and materials, e.g. to DIN EN 60228 Class 1 and 2
- ▶ Ideal for connecting identical and different conductor cross-sections
- ▶ Suitable cross-section range for street lighting

Characteristics

- Special groove profile inside to destroy the oxidation layer when crimping
- With inspection hole for monitoring full cable insertion

Material

- Insulated body: brass (CuZn)
- Screws: stainless steel, tin-plated

Surface

- Either bright or tin-plated

Technical instructions

- Refer to the installation instructions in the technical appendix on page i-8

Additional information

- rm = round multi-stranded; re = round single solid

Part No.	Nominal cross section mm ²		Dimension mm				Torque Nm	Weight/pcs. ~kg	Packing unit/ pcs
	re	rm	D	d1	L	AF			
With threaded pin, tin-plated									
SV200	1.5 - 16	1.5 - 16	10	5.5	30	2.5	4	1.35	4
With threaded pin, bright finished									
SV200BK	1.5 - 16	1.5 - 16	10	5.5	30	2.5	4	1.35	4