



### Cupal washers



#### Characteristics

- Flat washer for processing aluminium and copper cable lugs
- For connecting copper conductors to aluminium in dry environments
- For connecting aluminium conductors to copper in dry environments
- Can also be used for connecting tinned aluminium cable lugs in humid environments

#### Material

- E-Al, one side copper plated

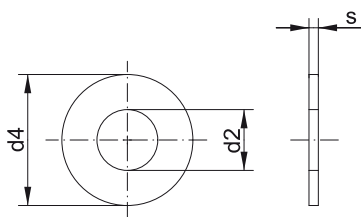

Size of bolt dia.	Part No.	Dimension mm			Weight 100 pcs. ~kg	Packing unit/pcs
		d2	d4	s		
M 6	<b>CS615</b>	6.5	15	2	0.06	10
M 8	<b>CS818</b>	8.5	18	2	0.09	10
M 10	<b>CS1022</b>	11.0	22	2	0.26	10
M 12	<b>CS1228</b>	13.0	28	2	0.44	10
M 14	<b>CS1428</b>	15.0	28	2	0.40	10
M 16	<b>CS1635</b>	17.0	35	2	0.66	10