

## Compression joint to DIN, Al, full tension



- ▶ For full tension connections of aluminium cables to DIN EN 50182
- ▶ To DIN 48085, Part 2
- ▶ With code number for clear tool assignment
- ▶ Filled with contact grease for optimum crimp characteristics

### Characteristics

- Easy to process due to crimp markings
- Simple cable entry due to internal chamfer

### Material

- E-aluminium to 95 mm<sup>2</sup>
- AlMgSi from 120 mm<sup>2</sup>

### Surface

- Bright

### Technical instructions

- Tool: see page 103

### Additional information

- \* = not standardised

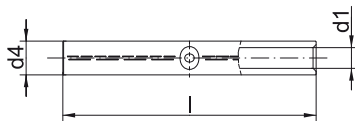

Nominal cross section mm <sup>2</sup>	Part No.	Hint	Code	Dimension mm			Number of crimps		Conductor mm dia.	Weight 100 pcs. ~kg	Packing unit/pcs
				d1	d4	l	Al (7 mm)	Al (wide)			
16	<b>243R</b>	*	12	5.8	12.0	140	8/8	4/4	5.1	3.4	10
25	<b>244R</b>		12	7.0	12.0	140	8/8	4/4	6.3	2.9	10
35	<b>245R</b>		14	8.2	14.0	140	8/8	4/4	7.5	3.9	10
50	<b>246R</b>		16	10.0	16.0	155	8/8	4/4	9.0	5.2	10
70	<b>247R</b>		18	11.5	18.5	165	8/8	4/4	10.5	7.4	10
95	<b>248R</b>		22	13.5	22.0	165	8/8	4/4	12.5	12.2	10
120	<b>249R</b>		25	15.5	25.5	250	12/12	6/6	14.0	21.8	10
150	<b>250R</b>		28	16.5	28.5	300	--	7/7	15.7	34.4	10
185	<b>251R</b>		28	18.5	28.5	330	--	7/7	17.5	33.0	5
240	<b>252R</b>		34	21.5	34.5	350	--	7/7	20.2	54.0	5
300	<b>253R</b>		38	23.5	38.5	400	--	8/8	22.5	79.0	1

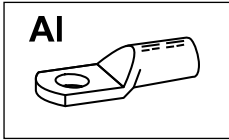

## Tool application chart

### Compression cable lugs and connectors made from E-AI

#### Compression cable lugs for full-tension connections from AI conductors DIN EN 50182, 16 - 95 mm<sup>2</sup>

Tool type	Crimping range corresponds to nominal cross-section mm <sup>2</sup>	Crimping Tool		Catalogue page		Crimp profile
		Part No.	Crimping head / adapter	Crimping Tool	Crimping die	
Mechanical, electrical, pneumatic crimping tools with interchangeable die / head	10 - 70	K354		236	317	
	10 - 185	K18		238	325	
	10 - 300	K22		240	330	
Hand hydraulic crimping tools	10 - 185	HK6018		280	325	
		HK60UNV	+UA18	465	325	
	10 - 300	HK6022		282	330	
		HK60UNV	+UA22	465	330	
		HK12030		286	336	
		HK12042		288	336	
		HK120U		290	336	
Battery powered crimping tools	10 - 70	EK354ML		250	317	
		EK354		256	317	
	10 - 150	EK505		258	321	
	10 - 185	EK5018		260	325	
		EK60UNV	+UA18	468	325	
		EKM60UNV	+UA18	467	325	
	10 - 300	EK6022		264	330	
		EKM6022		262	330	
	50 - 240	EKM60ID*		268		
	10 - 300	EK60UNV	+UA22	468	330	
		EKM60UNV	+UA22	467	330	
		EK120UNV		469		
		EK12032		270	336	
		EK12042		272	336	
		EK120U	+UA15T	274	336	
		EK135FT	+UA12T	276	336	
Hydraulic crimping systems	10 - 185	THK18		294	325	
	10 - 300	THK22		296	330	
		THK120		300	336	
	10 - 500	HK252	+25A13	308	336 + 340	
	150 - 500	HK45		309	342	
Hydraulic crimping heads	10 - 185	PK18		294	325	
		PK60UNV	+UA18	466	325	
	10 - 300	PK22		296	330	
		PK60UNV	+UA22	466	330	
		PK12042		300	336	
		PK120U		302	336	
	10 - 500	PK252	+25A13	304	336 + 340	
	50 - 240	PK60ID*		299		
	150 - 500	PK45		306	342	

\* Not suitable for full-tension connections