

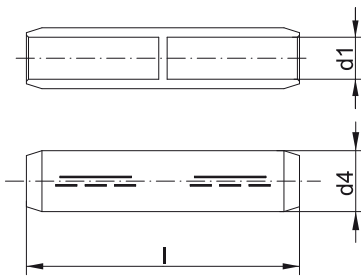

Compression joints, Al



- ▶ For non-tension connections of medium-voltage aluminium cable 10-30 kV
- ▶ For non-tension connections of aluminium conductors to DIN EN 60228 and aluminium cables to DIN EN 50182 and pre-rounded sector shaped conductors
- ▶ For pre-rounded sector shaped conductors
- ▶ Tube dimension to DIN 46267, Part 2
- ▶ With code number for clear tool assignment
- ▶ Filled with contact grease for optimum crimp characteristics

Characteristics

- Also available as barrier design with oil stop
- With chamfered edges for reduced wrapping during assembly
- Easy to process due to crimp markings
- Simple cable entry due to internal chamfer

Material

- E-aluminium

Surface

- Bright

Technical instructions

- Tool: see page 103

Additional information

- re = round single solid wire, rm = round multi-stranded, se = sector shaped single solid wire, sm = sector shaped multi-stranded, sector shaped conductors must be pre-rounded

Part No.	Nominal cross section mm ²		Code	Dimension mm			Number of crimps		Weight 100 pcs. ~kg	Packing unit/ pcs
	rm/sm	re/se		d1	d4	l	Al (7 mm)	Al (wide)		
Standard type										
405R	35	50	14	8.0	14	90	4/4	2/2	2.7	10
406R	50	70	16	9.8	16	90	4/4	2/2	3.4	10
407R	70	95	18	11.2	18.5	95	4/4	2/2	4.6	10
408R	95	120	22	13.2	22	100	4/4	2/2	6.8	10
409R	120	150	22	14.7	23	105	4/4	2/2	7.4	10
410R	150	185	25	16.3	25	105	4/4	2/2	8.7	10
411R	185	240	28	18.3	28.5	125	5/5	2/2	13.4	5
412R	240	300	32	21.0	32	125	5/5	2/2	15.7	5
413R	300	--	34	23.3	34	125	5/5	2/2	16.3	1
414R	400	--	38	27.0	38.5	150	--	3/3	25.8	1
Barrier version										
416R	50	70	16	9.8	16	95	4/4	2/2	5.6	5
417R	70	95	18	11.2	18.5	100	4/4	2/2	6.1	5
418R	95	120	22	13.2	22	105	4/4	2/2	9.2	5
419R	120	150	22	14.7	23	110	4/4	2/2	10.3	5
420R	150	185	25	16.3	25	110	4/4	2/2	12.0	5
421R	185	240	28	18.3	28.5	130	5/5	2/2	15.6	5
422R	240	300	32	21.0	32	130	5/5	2/2	19.1	5
423R	300	--	34	23.3	34	135	5/5	2/2	30.7	1
424R	400	--	38	26.0	38	165	--	3/3	30.0	1

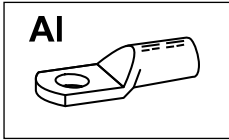

Tool application chart

Compression cable lugs and connectors made from E-AI

Compression cable lugs for full-tension connections from AI conductors DIN EN 50182, 16 - 95 mm²

Tool type	Crimping range corresponds to nominal cross-section mm ²	Crimping Tool		Catalogue page		Crimp profile
		Part No.	Crimping head / adapter	Crimping Tool	Crimping die	
Mechanical, electrical, pneumatic crimping tools with interchangeable die / head	10 - 70	K354		236	317	
	10 - 185	K18		238	325	
	10 - 300	K22		240	330	
Hand hydraulic crimping tools	10 - 185	HK6018		280	325	
		HK60UNV	+UA18	465	325	
	10 - 300	HK6022		282	330	
		HK60UNV	+UA22	465	330	
		HK12030		286	336	
		HK12042		288	336	
		HK120U		290	336	
Battery powered crimping tools	10 - 70	EK354ML		250	317	
		EK354		256	317	
	10 - 150	EK505		258	321	
	10 - 185	EK5018		260	325	
		EK60UNV	+UA18	468	325	
		EKM60UNV	+UA18	467	325	
	10 - 300	EK6022		264	330	
		EKM6022		262	330	
		50 - 240	EKM60ID*		268	
	10 - 300	EK60UNV	+UA22	468	330	
		EKM60UNV	+UA22	467	330	
		EK120UNV		469		
		EK12032		270	336	
		EK12042		272	336	
		EK120U	+UA15T	274	336	
		EK135FT	+UA12T	276	336	
Hydraulic crimping systems	10 - 185	THK18		294	325	
	10 - 300	THK22		296	330	
		THK120		300	336	
	10 - 500	HK252	+25A13	308	336 + 340	
	150 - 500	HK45		309	342	
Hydraulic crimping heads	10 - 185	PK18		294	325	
		PK60UNV	+UA18	466	325	
	10 - 300	PK22		296	330	
		PK60UNV	+UA22	466	330	
		PK12042		300	336	
		PK120U		302	336	
	10 - 500	PK252	+25A13	304	336 + 340	
	50 - 240	PK60ID*		299		
	150 - 500	PK45		306	342	

* Not suitable for full-tension connections