

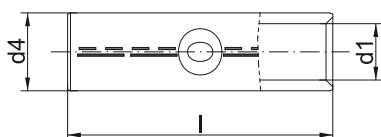

Compression joints to DIN, Cu



- ▶ For round conductors, e.g. to DIN EN 60228 Cl. 1, 2, 5 and 6 and pre-rounded sector shaped conductors
- ▶ For non-tension copper cables, e.g. to DIN 48201-1
- ▶ To DIN 46267, Part 1
- ▶ With code number for clear tool assignment
- ▶ With crimp markings for correct crimp positioning

Characteristics

- Simple and safe processing due to butt mark
- Annealed material optimises material and crimping properties
- Simple cable entry due to internal chamfer

Material

- Copper (EN13600)

Surface

- Tin-plated to protect against corrosion

Technical instructions

- Tool: see page 69
- Reduction sleeves for connecting unequal cross-sections can be found on page 68

Additional information

- Possible as a special bright version on request. Part Number appendix „BK“
- 10 - 800 mm² IEC-tested

Nominal cross section mm ²	Part No.	Code	Dimension mm			Weight/ 100 pcs. ~ kg	Packing unit/pcs
			d1	d4	l		
6	121R	5	3.8	5.5	30	0.31	100
10	122R	6	4.5	6.0	30	0.34	100
16	123R	8	5.5	8.5	50	1.45	100
25	124R	10	7.0	10.0	50	1.77	50
35	125R	12	8.2	12.5	50	2.89	50
50	126R	14	10.0	14.5	56	4.26	50
70	127R	16	11.5	16.5	56	5.41	50
95	128R	18	13.5	19.0	70	8.62	25
120	129R	20	15.5	21.0	70	9.66	25
150	130R	22	17.0	23.5	80	14.50	10
185	131R	25	19.0	25.5	85	17.00	10
240	132R	28	21.5	29.0	90	23.41	10
300	133R	32	24.5	32.0	100	29.23	5
400	134R	38	27.5	38.5	150	74.32	5
500	135R	42	31.0	42.0	160	89.09	1
625	136R	44	34.5	44.0	160	79.10	1
800	137R	52	40.0	52.0	200	151.00	1
1000	138R	58	44.0	58.0	200	198.00	1

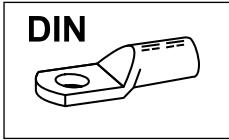

Tool application chart

Compression cable lugs and compression joints

Tool type	Crimping range corresponds to nominal cross-section mm ²	Crimping Tool		Catalogue page		Crimp profile
		Part No.	Crimping head / adapter	Crimping Tool	Crimping die	
Mechanical crimping tools	6 - 50	K05D		230		⬡
	6 - 120	K06D		231		⬡
	25 - 150	K09D		233		⬡
Mechanical, electrical, pneumatic crimping tools with interchangeable dies / heads	6 - 25	K50		235	312	⬡
		EK50ML		244	312	⬡
	6 - 120	K354		236	316	⬡
	6 - 185	K18		238	324	⬡
	6 - 300	K22		240	329	⬡
Hand hydraulic crimping tools	6 - 185	HK6018		280	324	⬡
		HK60UNV	+UA18	465	324	⬡
	6 - 300	HK6022		282	329	⬡
		HK60UNV	+UA22	465	329	⬡
	10 - 300	HK12030		286	334	⬡
		HK12042		288	334	⬡
		HK120U		290	334	⬡
	120 - 1000	HK45		309	342	⬡
Battery powered crimping tools	6 - 120	EK354ML		250	316	⬡
		EK354		256	316	⬡
	6 - 185	EK505		258	320	⬡
		EK5018		260	324	⬡
		EK60UNV	+UA18	468	324	⬡
		EKM60UNV	+UA18	467	324	⬡
	6 - 300	EK6022		264	329	⬡
		EKM6022		262	329	⬡
		EK60UNV	+UA22	468	329	⬡
		EKM60UNV	+UA22	467	329	⬡
	10 - 300	EK12032		270	334	⬡
		EK12042		272	334	⬡
		EK120U		274	334	⬡
		EK120UNV	+UA12T	469	334	⬡
EK135FT		+UA15T	276	334	⬡	
400 - 625	EK135FT		276	338	⬡	
Hydraulic crimping systems	6 - 185	THK18		294	324	⬡
	6 - 300	THK22		296	329	⬡
	10 - 625	HK252	+25A13	308	334+339	⬡
Hydraulic crimping heads	6 - 185	PK18		294	324	⬡
		PK60UNV	+UA18	466	324	⬡
	6 - 300	PK22		296	329	⬡
		PK60UNV	+UA22	466	329	⬡
	10 - 300	PK12042		300	334	⬡
		PK120U		302	334	⬡
	10 - 625	PK252	+25A13	304	334+339	⬡
120 - 1000	PK45		306	342	⬡	