

Butt connectors, Cu, solid conductor type



- ▶ For single-stranded round conductors, e.g. to DIN EN 60228 Cl. 1
- ▶ Also pre-rounded sector shaped conductors
- ▶ Safe and secure connecting of solid conductors
- ▶ Ideal for repairing damaged NYM cables

Characteristics

- Annealed material optimises material and crimping properties
- Simple cable entry due to internal chamfer

Material

- Copper (EN13600)

Surface

- Tin-plated to protect against corrosion

Technical instructions

- Tool: see page 44

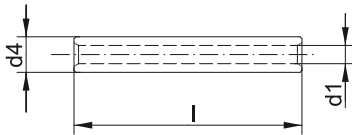

Nominal cross section mm ²	Part No.	Dimension mm			Weight/ 100 pcs. ~ kg	Packing unit/pcs
		d1	d4	l		
1.5-2.5	SV1525	2.0	3.9	25	0.210	100
4	SV4	2.4	4.4	25	0.240	100
6	SV6	3.0	5.0	25	0.275	100
10	SV10	4.0	6.0	25	0.350	100
16	SV16	5.0	8.0	35	0.960	100
25	SV25	6.2	10.0	40	1.700	50
35	SV35	7.0	10.0	40	1.420	50
50	SV50	8.5	12.0	70	3.550	50

T-connectors, Cu, solid conductor type



- ▶ For single-stranded round conductors, e.g. to DIN EN 60228 Cl. 1
- ▶ Also pre-rounded sector shaped conductors
- ▶ Safe and secure connecting of solid conductors
- ▶ Special version for cable tap conductors

Characteristics

- Annealed material optimises material and crimping properties
- Simple cable entry due to internal chamfer

Material

- Copper (EN13600)

Surface

- Tin-plated to protect against corrosion

Technical instructions

- Tool: see page 44

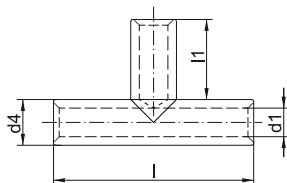

Nominal cross section mm ²	Part No.	Dimension mm				Draht-Ø mm	Weight/ 100 pcs. ~ kg	Packing unit/pcs
		d1	d4	l	l1			
1.5-2.5	STV1525	1.9	3.9	30	12	1.38/1.78	0.34	50
4	STV4	2.4	4.4	30	12	2.25	0.40	50
6	STV6	3.0	5.0	30	12	2.75	0.48	50
10	STV10	4.0	6.0	35	14	3.55	0.72	50
16	STV16	5.0	8.0	35	14	4.5	1.40	50
25	STV25	6.2	10.0	50	21	5.65	3.20	25
35	STV35	7.0	10.0	55	23	6.7	2.95	25
50	STV50	8.5	12.0	76	32	8	5.60	25