

21-V-310 Extension for Internal Extractor (100 mm Extension, Mounting Thread M10)



DESCRIPTION

The extensions for the internal extractors of series 21 are used for loosening and pulling out deeply seated bearings, bearing outer rings, and bushes in crafts, workshops, and industry. The extensions available in various lengths from 40 to 280 mm allow for a variable application of the internal extractors even in extreme cases.

APPLICATION AREA

For loosening and extracting deep-seated bearings, bearing outer rings and bushings

BENEFIT

- Various extension sizes for different applications

MASTER DATA

GTIN [EAN]	4021176914386
Country of origin	DE
Case material	Tool steel
Series	21-V
Net weight [kg]	0,295 kg
Package contents	1 piece
Packaging Act	PP 05
Global sales capability given	Yes (REACH, RoHS, POP, PROP65, TSCA)

SUITABLE FOR

- 21-3_2-jaw internal extractor
- 21-4_2-jaw internal extractor
- 21-5_2-jaw internal extractor

Extension for Internal Extractor (100 mm Extension, Mounting Thread M10)

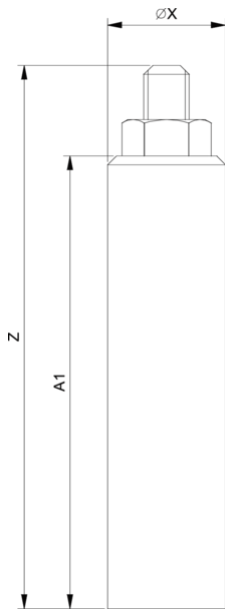

Abbreviation	Attribut	Wert
Z	Total height [mm]	120 mm
S1	Width across flats [mm]	17 mm
T	Mounting thread [nominal dimension]	M10
X	Diameter [mm]	20 mm
A1	Length by which is extended [mm]	100 mm

Abbreviation	Attribut	Wert
Z	Total height [mm]	120 mm
S1	Width across flats [mm]	17 mm
T	Mounting thread [nominal dimension]	M10
X	Diameter [mm]	20 mm
A1	Length by which is extended [mm]	100 mm

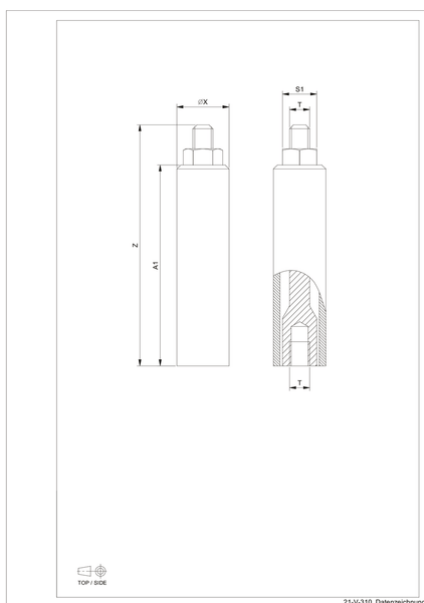

Abbreviation	Attribut	Wert
Z	Total height [mm]	120 mm
S1	Width across flats [mm]	17 mm
T	Mounting thread [nominal dimension]	M10
X	Diameter [mm]	20 mm
A1	Length by which is extended [mm]	100 mm