

21-7-E Segment internal extractor with spread 63 mm - 78 mm, 82 mm reach



APPLICATION IMAGE



DETAIL IMAGE

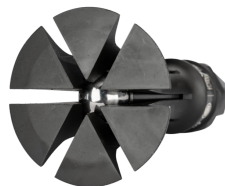

DESCRIPTION

The Segment Internal Extractors of the 21-E series with 15-16 Gang thread are used for extracting flat-mounted bearings, bearing outer rings, sockets, and seals in crafts, workshops, and industry. The segmented design with extra fine gripping edges allows for the safe extraction of flat-mounted parts. The 21 series impresses with its compatibility and variety of applications. Depending on the application, there are numerous variants of the Segment Internal Extractors. They are used either together with counter stays or with sliding hammers.

APPLICATION AREA

For extracting flat bearings, bearing outer rings and bushes

BENEFIT

- Due to its segmentation and fine spindle design, the segment puller is ideal for precise and gentle work.
- The mechanical spindle extracts bearings that are tightly seated on the back wall safely and quickly.
- The shaping ensures a secure grip when seating and swiveling for bearings or inner rings that form a blind hole.
- The thread adapters for internal extractors are included in the delivery of the counter stays and sliding hammers.

OPERATION

- Determine the inner diameter of the ball bearing and select the appropriate internal puller
- Insert the internal puller into the hole and tighten the locking nut
- If a support surface is available, choose the counter stay; otherwise, select the sliding hammer

Operation with counter stay: Support the counter stay on the housing and screw it onto the wedge spindle of the internal puller

- Hold the handle of the counter stay and safely pull out the bearing by tightening the nut
- Retighten the locking nut while pulling out

Operation with sliding hammer: Screw the sliding hammer rod onto the wedge spindle of the internal puller

- Use the sliding hammer with a striking motion to pull out the bearing

MASTER DATA

| | |
|-------------------------------|--------------------------------------|
| GTIN [EAN] | 4021176924095 |
| Country of origin | DE |
| Case material | Tool steel |
| Series | 21-E |
| Net weight [kg] | 0,86 kg |
| Package contents | 1 piece |
| Packaging Act | PAP 21 |
| Global sales capability given | Yes (REACH, RoHS, POP, PROP65, TSCA) |

SUITABLE FOR

- 22-0-17 Sliding Hammer Device with 1.7 kg Impact Weight
- 22-2_Counter Stay

Segment internal extractor with spread 63 mm - 78 mm, 82 mm reach

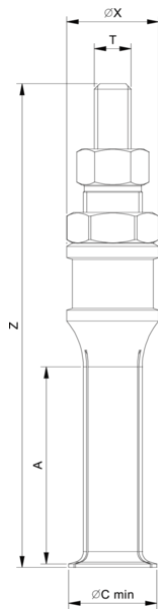

| Abbreviation | Attribut | Wert |
|--------------|-------------------------------------|------------|
| Z | Total height [mm] | 165 mm |
| S1 | Width across flats [mm] | 24 mm |
| S2 | Width across flats [mm] | 32 mm |
| Emin | Span inside pull-out (min.) [mm] | 63 mm |
| Emax | Span inside pull-out (max.) [mm] | 78 mm |
| X | Diameter of the extractor [mm] | 35 mm |
| T | Mounting thread [nominal dimension] | 15-16 Gang |

| Abbreviation | Attribut | Wert |
|--------------|-------------------------------------|------------|
| Z | Total height [mm] | 165 mm |
| S1 | Width across flats [mm] | 24 mm |
| S2 | Width across flats [mm] | 32 mm |
| Emin | Span inside pull-out (min.) [mm] | 63 mm |
| Emax | Span inside pull-out (max.) [mm] | 78 mm |
| X | Diameter of the extractor [mm] | 35 mm |
| T | Mounting thread [nominal dimension] | 15-16 Gang |