

41-5-B 2-jaw universal puller with swiveling jaws, grease hydraulic spindle, up to 180 mm spread, 200 mm reach



DESCRIPTION

The 2-jaw universal puller with swiveling jaws and hydraulic spindle is used for pulling bearings, gears and discs in all common sizes for crafts, workshops, and industry. The hydraulic spindle achieves an average pulling force of up to 10 t. This allows for loosening any component that is mounted on a shaft and is freely accessible from the outside. The swiveling jaws also provide maximum freedom of movement for individual adaptation to the respective spread and depth, even under restricted environmental conditions. For pulling operations in tight spaces, the mechanical spindle can be utilized.

APPLICATION AREA

For pulling off bearings, gears and pulleys

BENEFIT

- Swiveling puller jaws allow for work in tight spaces while simultaneously providing individual adjustment for spread and reach.
- The hydraulic spindle guarantees easy and controlled removal of particularly tight-fitting parts with minimal effort.
- In limited spatial conditions that require direct access to the component, the mechanical spindle can be used.
- The mechanical spindle features a rotatable spindle tip for safe placement on smooth surfaces and during centering.
- Anti-slip safety (spindle neck) at the spindle head for safe working with wrench.
- Spindle outlet to protect the thread

OPERATION

- Swing the jaws from the outside onto the part to be removed
- Slide the claws underneath the component
- Operate the hexagon at the spindle head with a ratchet or a ring spanner
- Reapply the hydraulic spindle until the component is loosened

MASTER DATA

GTIN [EAN]	4021176887345
Country of origin	DE
Case material	Tool steel
Series	41-B
Net weight [kg]	4,875 kg
Package contents	1 piece
Packaging Act	PP 05
Global sales capability given	Yes (REACH, RoHS, POP, PROP65, TSCA)

SPARE PARTS

- 201-2-T_Crossbar
- 41-5-200-P_2 jaws (pair)
- 621300_Mechanical pressure spindle
- 8-0-621_hydraulic spindle
- Hydraulic spindle

2-jaw universal puller with swiveling jaws, grease hydraulic spindle, up to 180 mm spread, 200 mm reach

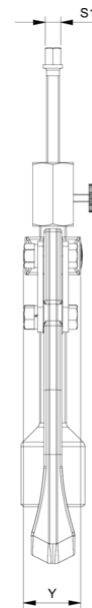
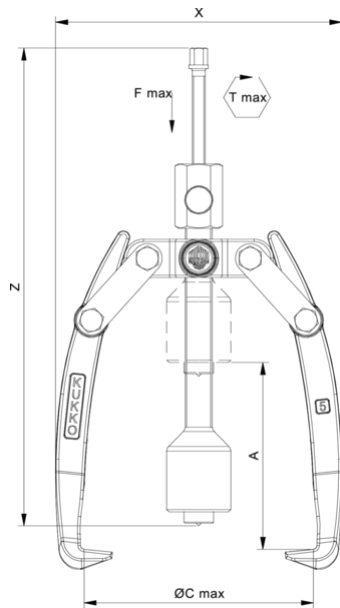

Abbreviation	Attribut	Wert
X	Total width [mm]	204 mm
Y	Total depth [mm]	42 mm
Z	Total height [mm]	420 mm
A	Clamping depth outside pull-off [mm]	200 mm
S1	Width across flats [mm]	12 mm
Cmin	Span outside pull-off (min.) [mm]	0 mm
Cmax	Span outside pull-off (max.) [mm]	180 mm
K	Hook root thickness at the tip (claw thickness K) [mm]	5 mm
J	Hook base width (claw width J) [mm]	34 mm
O	Hook base depth usable (claw depth usable O) [mm]	23 mm
H	Total hook root depth (total claw depth H) [mm]	35 mm
L	Total claw thickness (L+1mm) (claw distance to base surface) [mm]	15 mm
Tmax	Max. torque [Nm]	15 Nm
Fmax	Max. tractive force [t]	10 t
Fmax	Max. tensile force [kN]	100 kN

Abbreviation	Attribut	Wert
X	Total width [mm]	204 mm
Y	Total depth [mm]	42 mm
Z	Total height [mm]	420 mm
A	Clamping depth outside pull-off [mm]	200 mm
S1	Width across flats [mm]	12 mm
Cmin	Span outside pull-off (min.) [mm]	0 mm
Cmax	Span outside pull-off (max.) [mm]	180 mm
K	Hook root thickness at the tip (claw thickness K) [mm]	5 mm
J	Hook base width (claw width J) [mm]	34 mm
O	Hook base depth usable (claw depth usable O) [mm]	23 mm
H	Total hook root depth (total claw depth H) [mm]	35 mm
L	Total claw thickness (L+1mm) (claw distance to base surface) [mm]	15 mm
Tmax	Max. torque [Nm]	15 Nm
Fmax	Max. tractive force [t]	10 t
Fmax	Max. tensile force [kN]	100 kN

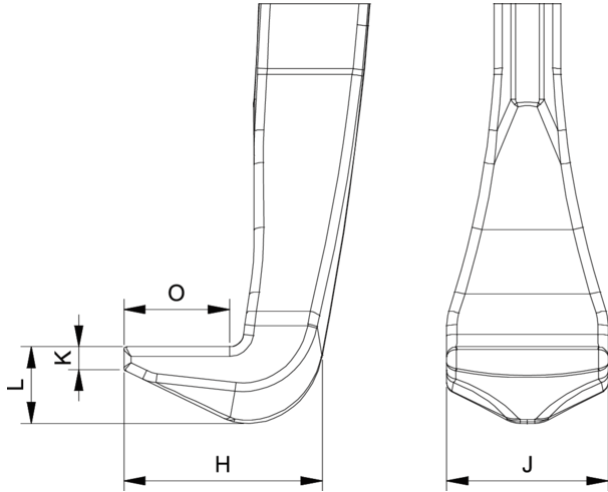

Abbreviation	Attribut	Wert
X	Total width [mm]	204 mm
Y	Total depth [mm]	42 mm
Z	Total height [mm]	420 mm
A	Clamping depth outside pull-off [mm]	200 mm
S1	Width across flats [mm]	12 mm
Cmin	Span outside pull-off (min.) [mm]	0 mm
Cmax	Span outside pull-off (max.) [mm]	180 mm
K	Hook root thickness at the tip (claw thickness K) [mm]	5 mm
J	Hook base width (claw width J) [mm]	34 mm
O	Hook base depth usable (claw depth usable O) [mm]	23 mm
H	Total hook root depth (total claw depth H) [mm]	35 mm
L	Total claw thickness (L+1mm) (claw distance to base surface) [mm]	15 mm
Tmax	Max. torque [Nm]	15 Nm
Fmax	Max. tractive force [t]	10 t
Fmax	Max. tensile force [kN]	100 kN

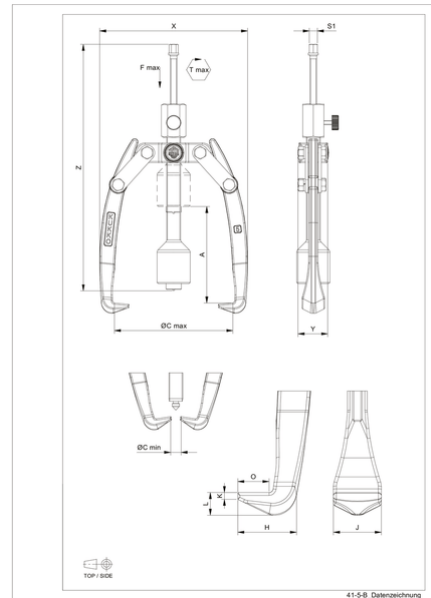

Abbreviation	Attribut	Wert
X	Total width [mm]	204 mm
Y	Total depth [mm]	42 mm
Z	Total height [mm]	420 mm
A	Clamping depth outside pull-off [mm]	200 mm
S1	Width across flats [mm]	12 mm
Cmin	Span outside pull-off (min.) [mm]	0 mm
Cmax	Span outside pull-off (max.) [mm]	180 mm
K	Hook root thickness at the tip (claw thickness K) [mm]	5 mm
J	Hook base width (claw width J) [mm]	34 mm
O	Hook base depth usable (claw depth usable O) [mm]	23 mm
H	Total hook root depth (total claw depth H) [mm]	35 mm
L	Total claw thickness (L+1mm) (claw distance to base surface) [mm]	15 mm
Tmax	Max. torque [Nm]	15 Nm
Fmax	Max. tractive force [t]	10 t
Fmax	Max. tensile force [kN]	100 kN