

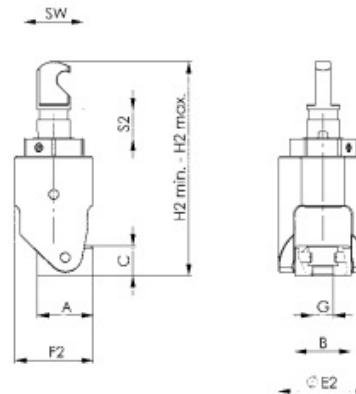

**No. 6540H**  
**Hook end, mechanical**

Order no.	Size	Slot	G	max. permissible torque [Nm]	max. possible clamping force [kN]	SW	Weight [g]
374934	M12	14, 16, 18	M12	45	15	36	853
374959	M16	18, 20, 22, 24	M16	90	40	46	1902
376517	M20	22-28	M20	190	75	65	6037
376533	M24	28-36	M24	300	120	65	6040



**Dimensions:**

Order no.	Size	A	B	C	E2	F2	H2 min.	H2 max.	Clamping stroke S2
374934	M12	36	36	18	54	49	111	127	16
374959	M16	37	44	25	70	62	140	170	30
376517	M20	58	64	41	98	80	220	272	52
376533	M24	58	64	41	98	80	222	285	63